

ITEM NO.	PART NO.	DESCRIPTION	QTY.	MSRP
1	H505A	jet, s/s, 1/8", 1502	2	\$9.99 ea
2	H425	spray bar, 4"	1	\$117.99 ea
3	G111	brush, corner spinner	1	\$29.99 ea
4	P593	glide, nylon, corner spinner	1	\$19.99 ea
5	P701	manifold, counter tool	1	\$35.99 ea
6	H230	screw, 10-32 x 1/2" phil pan head, s/s	8	\$0.99 ea
7	H926	swivel, spinner	1	\$198.99 ea
8	H289	washer #10 flat, s/s	9	\$0.99 ea
9	H482	casting, counter spinner	1	\$27.99 ea
10	B107	nipple, brass, 1/4"m, hex	1	\$3.19 ea
11	B130	45 deg, street elbow, brass, 1/4" male	1	\$5.49 ea
12	H540	gun, high pressure	1	\$41.99 ea
13	B105	bushing, brass, 3/8"mpt x 1/4"	1	\$3.19 ea
14	AH195	sol hose, 57" x 1/4", (OAL), m	1	\$37.99 ea
15	B247	filter, in-line, 100 mesh, 1/4" MPT x FPT	1	\$13.99 ea
16	B101	qd, brass, 1/4" m	1	\$8.49 ea
17	H655	coupler, 1-1/2" barb to barb fitting	1	\$8.99 ea
18	H300	cuff, hose, 1-1/2 x 1-1/2, wire	2	\$5.99 ea
19	H504	vac hose, 4' x 1-1/2", 1sw cu	1	\$19.49 ea

ITEMS NOT SHOWN

PART NO.	DESCRIPTION	QTY.	MSRP
G079	hose wrap, heat guard	1	\$2.99 ea

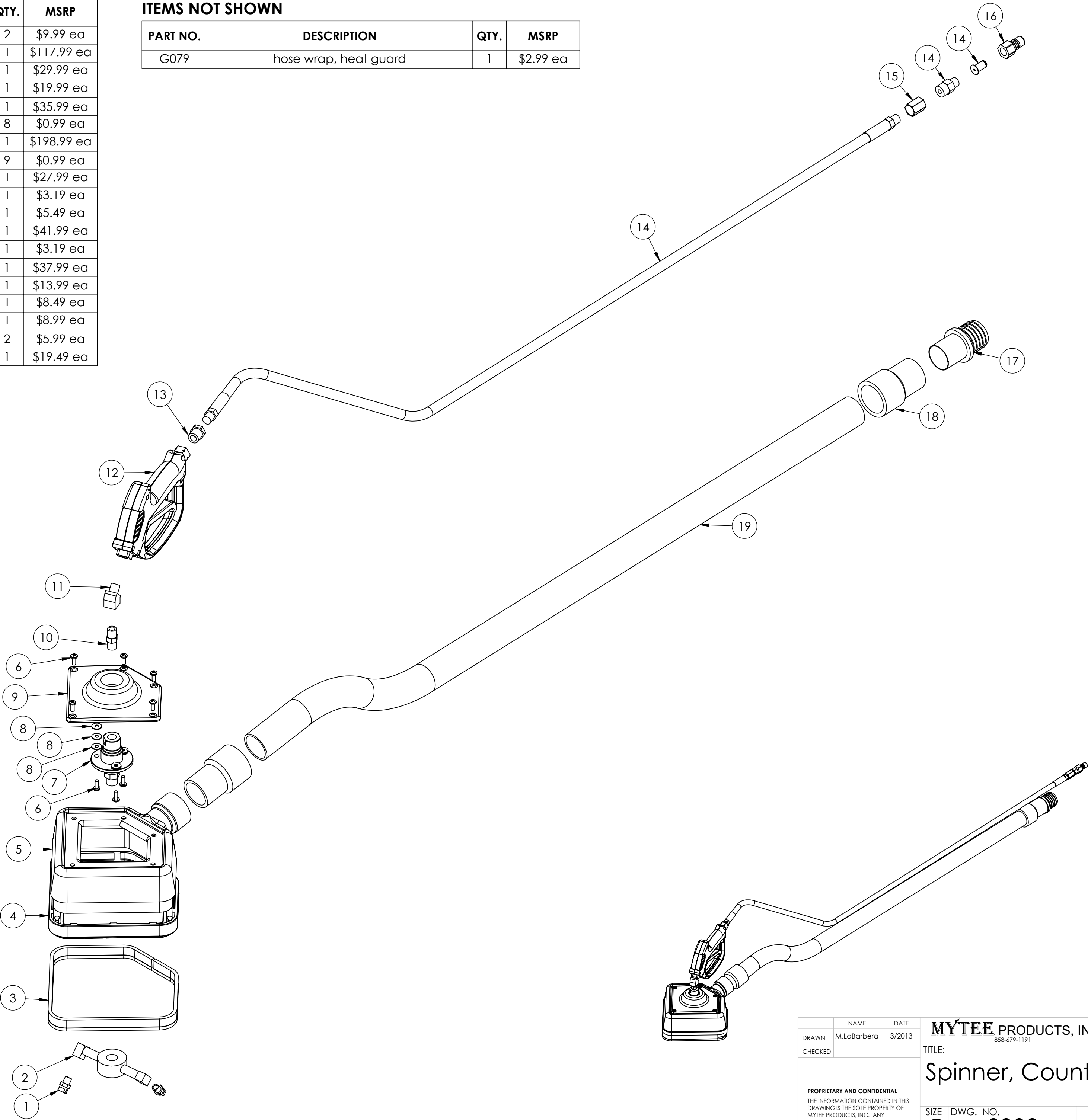

	NAME	DATE	MYTEE PRODUCTS, INC. 858-679-1191	
DRAWN	M.LaBarbera	3/2013		
CHECKED			TITLE: Spinner, Counter	
PROPRIETARY AND CONFIDENTIAL THE INFORMATION CONTAINED IN THIS DRAWING IS THE SOLE PROPERTY OF MYTEE PRODUCTS, INC. ANY REPRODUCTION IN PART OR AS A WHOLE WITHOUT THE WRITTEN PERMISSION OF MYTEE PRODUCTS, INC. IS PROHIBITED.			SIZE C	DWG. NO. 8908
			SCALE: 1:4	REV B
			DO NOT SCALE DRAWING	SHEET 1 OF 1