

User Manual



ORBITAL

Model: ECO-13, ECO-17
Orbital All-Surface Floor Machine

REV. 3/5/18

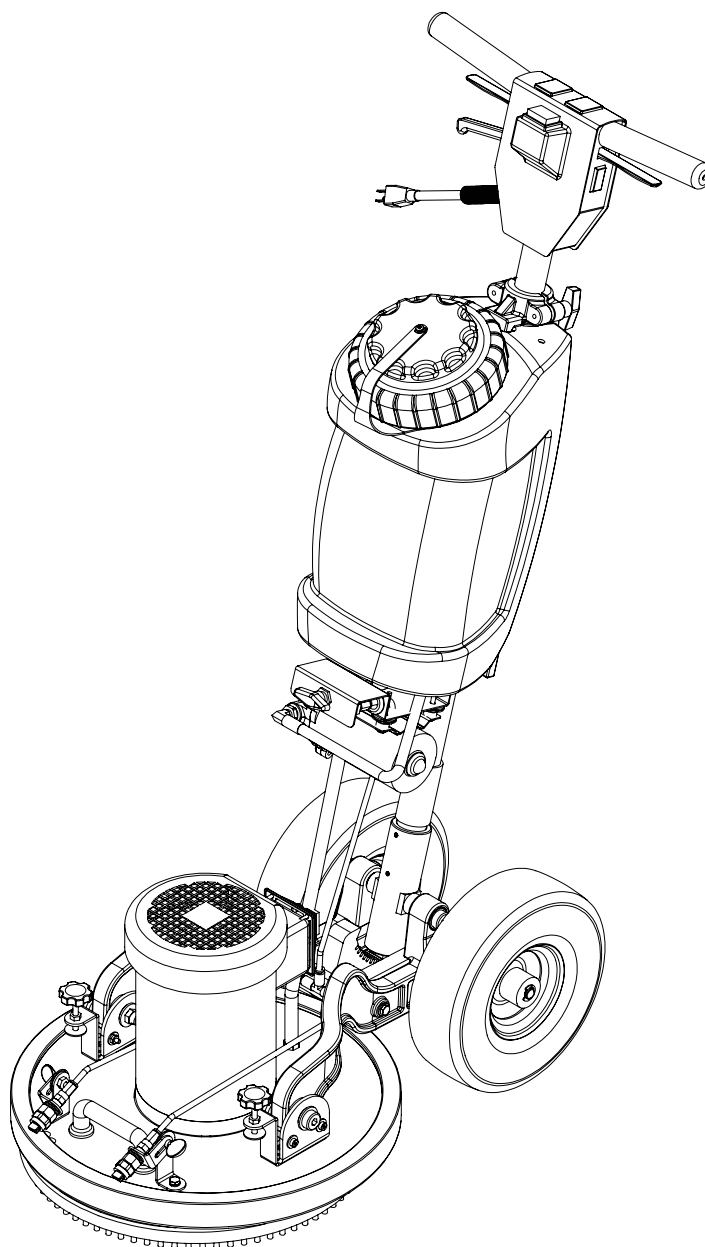

13655 Stowe Dr. Poway, CA 92064 • P: (858) 679-1191 • F: (858) 726-6005

[New & Reconditioned Equipment & Parts - www.southeasternequipment.net](http://www.southeasternequipment.net)

Dear Customer:

Congratulations on the purchase of your new Orbital All-Surface Floor Machine.

As technology continues to develop you can work confidently knowing that both Mytee Products and its employees are equally dedicated to developing with the industry and its advances.

Like any other piece of machinery or technology, the Orbital Floor Machines also require proper maintenance and care to keep the product working over extended use. Neglecting your machine, abusing it or not operating it properly can void its warranty and prevent the machine from performing to the quality and standard you'd expect out of the Mytee Products line.

If you have any warranty concerns or questions, please review this manual thoroughly or do not hesitate to contact your distributor. If there are questions regarding maintenance, replacement, or ordering parts please contact an authorized Mytee Products Service Center. To see an updated list please visit our website at <http://www.mytee.com/support/service-centers>.

Before using your Mytee product, please read this manual thoroughly.

*Sincerely,
Mytee Customer Care Dept.*

	IMPORTANT SAFETY INFORMATION	<u>4</u>
1	AT A GLANCE	<u>6</u>
	1.1 - Technical Specifications.....	<u>6</u>
	1.2 - Included with the Orbital Floor Machines	<u>6</u>
	1.3 - Orbital Floor Machine Front View	<u>7</u>
	1.4 - Orbital Floor Machine Rear View	<u>8</u>
	1.5 - Gravity Feed/Spray Jets Selector Valve.....	<u>9</u>
2	MACHINE OPERATION	<u>10</u>
	2.1 - Powering the Orbital Floor Machines	<u>10</u>
	2.2 - Pad Drivers, Pads, and Brushes	<u>10</u>
	2.3 - Filling the Shampoo Tank	<u>10</u>
	2.4 - Operating the Orbital Floor Machine	<u>11</u>
	2.5 - Emptying the Shampoo Tank	<u>11</u>
3	MACHINE MAINTENANCE	<u>12</u>
	3.1 - Flywheel Bearing Replacement	<u>12</u>
	3.2 - Flywheel Replacement.....	<u>13</u>
4	TROUBLESHOOTING	<u>14</u>

IMPORTANT SAFETY INFORMATION

Grounding Instructions

This machine must be grounded. If it should malfunction or breakdown, grounding provides a path of least resistance for electrical shock. This machine is equipped with a cord having an equipment-grounding conductor and grounding plug. The plug must be plugged into an appropriate outlet that is properly installed in accordance with all local code and ordinances. Do not remove ground pin; if missing, replace plug before use.



Improper installation of the equipment-grounding conductor can result in a risk of electric shock. Be sure to check with a qualified electrician or service person if you are in doubt as to whether the outlet is properly grounded. If the plug will not fit in the outlet do not modify either the plug nor the machine's cord, instead have a proper outlet installed by a qualified technician.

This machine is for use on a nominal 120-volt circuit and with a grounding plug similar to the one in Figure 1 below. If a proper outlet is not available, follow the illustrations of Figure 2 & 3 to install a temporary-grounding plug. This temporary work-around should be used only until a proper outlet (Figure 1) can be installed by a qualified electrician. When and if this type of adapter is employed, screw the adapter's extended tab into place with a metal screw. However, grounding adapters are not approved for use in Canada.

Again, be sure to check the grounding pin for damages and replace if necessary.

The Green, or Green-Yellow, wire in the cord is the grounding wire. When replacing a plug, this wire must be attached to only the grounding pin.

DO NOT use extension cords.

Please Note for America use only.

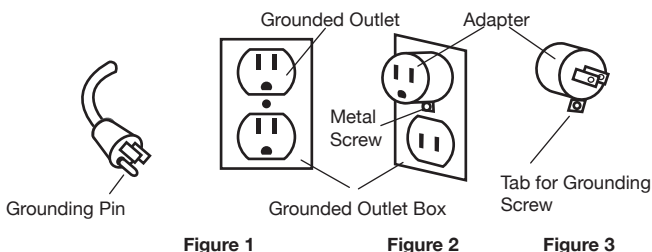

Parts and Service

Please contact a Mytee service personnel or Mytee authorized Service Center using Mytee original replacement parts and accessories for repairs are needing to be performed. When and if calling Mytee for support, please have your Model and Serial Number available for faster assistance.

Name Plate

The Model and Serial Number are located on the lower half of the back of the machine near the power plugs and will be required for ordering replacement parts. You can use the space provided on the front of this manual to note down both for future referencing.

Unpacking the Machine

When your new machine is delivered, please carefully inspect both the shipping carton and the machine for damages. If damage is evident, save both the shipping carton and machine so that the delivering carrier can inspect it. Contact the carrier immediately to file a freight claim if there has been any damage.

Caution and Warnings

Symbols

Mytee uses the symbols below to signal potentially dangerous conditions. Always read this information carefully and take the necessary steps to protect personnel and property.



Is used to warn of immediate hazards that will cause severe personal injury or death.



Is used to call attention to a situation that could cause severe personal injury.



Is used to call attention to a situation that could cause minor personal injury or damage to the machine or other property. When using an electrical appliance, basic precautions should always be followed, including the following: Read all instructions before using this machine. This

product is intended for commercial use only.

To reduce the risk of fire, electrical shock, or injury:

1. Read all instructions before using equipment.
2. Use only as described in this manual. Use only manufacturer's recommended attachments.
3. Always unplug power cord from electrical outlet before attempting any adjustments or repairs.
4. Do not unplug by pulling on cord. To unplug, grasp the plug, not the cord.
5. Do not pull or carry by cord. Do not close a door on cord or pull cord around sharp edges or corners.
6. Do not run appliance over cord. Keep cord away from heated surfaces.
7. Do not use with damaged cord or plug. If cord is damaged, repair immediately.
8. Do not use outdoors or on wet surfaces and or standing water.
9. Always unplug or disconnect the appliance from power supply when not in use.
10. Do not allow to be used as a toy. Close attention is necessary when used by or near children.
11. Do not use in areas where flammable or combustible material may be present.
12. Do not leave the unit exposed to harsh weather elements. Temperatures below freezing may damage components and void warranty.
13. Use only the appropriate handles to move and lift unit. Do not use any other parts of this machine for this purpose.
14. Keep hair, loose clothing, fingers, and all parts of the body away from all openings and moving parts.
15. Use extra care when using on stairs.
16. To reduce the risk of fire or electric shock, do not use this machine with a solid-state speed control device.
17. The voltage and frequency indicated on the name plate must correspond to the wall receptacle supply voltage.
18. When cleaning and servicing the machine, local or na-

tional regulations may apply to the safe disposal of liquids which may contain: chemicals, grease, oil, acid, alkalines, or other dangerous liquids.

19. Do not leave operating unattended.

1 - AT A GLANCE

1.1 - Technical Specifications

ECO-13

Cleaning Path	13"
Solution Tank	4 Gallons
Motor	1 Horsepower
Pump PSI	100
Pump GPM	1.3
Power Consumption	20 amps @ 115V 60Hz
Machine Weight	100 lbs.
Machine Dimensions	26" x 13.5" x 48.5"
Power Cord	Single 50' 12/3

ECO-17

Cleaning Path	17"
Solution Tank	4 Gallons
Motor	1 Horsepower
Pump PSI	100
Pump GPM	1.3
Power Consumption	20 amps @ 115V 60Hz
Machine Weight	130 lbs.
Machine Dimensions	28" x 17.5" x 48.5"
Power Cord	Single 50' 12/3

1.2 - Included with the Orbital Floor Machines

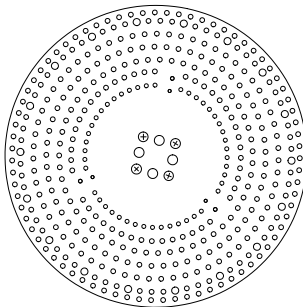

Pad Driver



Two Cleaning Pads

1.3 - Orbital Floor Machine Front View

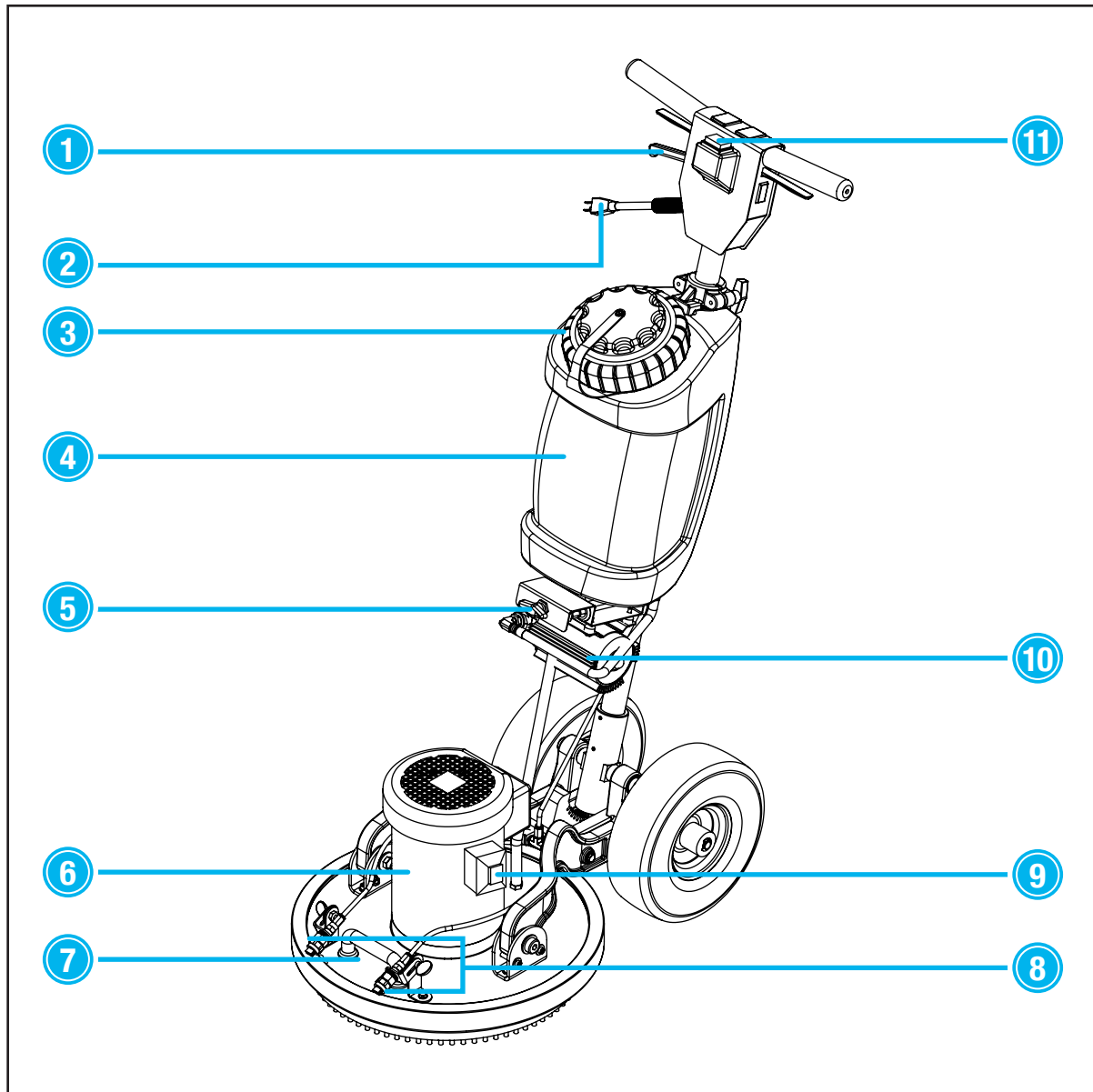

1. Handle Height Adjustment
Lever

2. Power Cord Pigtail

3. Solution Tank Lid

4. 4 Gallon Solution Tank

5. Gravity Feed/Spray Jets
Selector Valve

6. 1 Horsepower Motor

7. Lifting Handle

8. Forward-Facing Spray Jets

9. Head Rotation Direction
Selector Switch

10. 100 PSI Diaphragm Pump

11. Power Switch

1.4 - Orbital Floor Machine Rear View

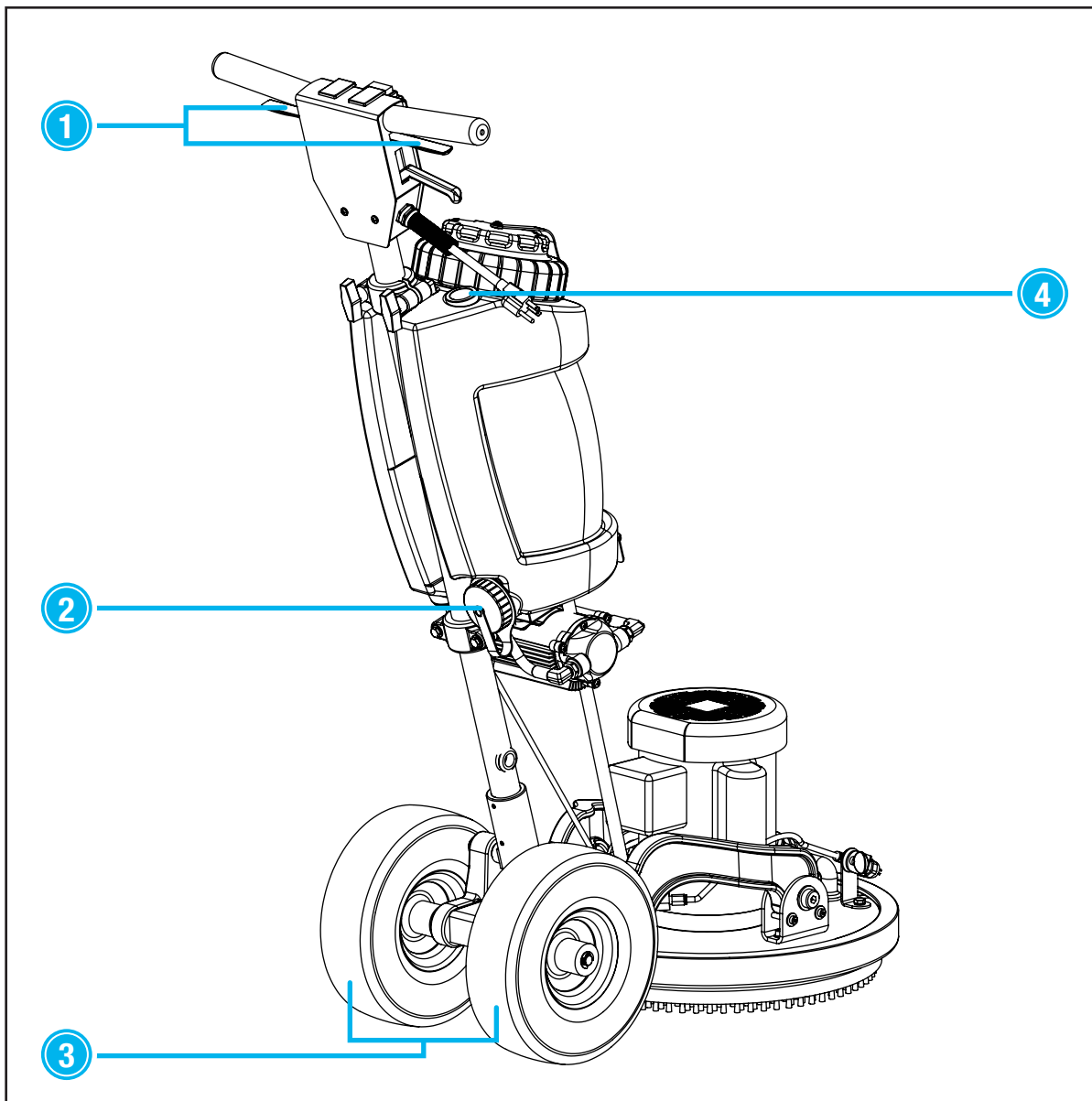

- 1. Solution Spray Levers
- 2. Solution Tank Drain Cap

- 3. 10" Foam-Filled Wheels
- 4. Faucet Fill Hose

1.5 - Gravity Feed/Spray Jets Selector Valve

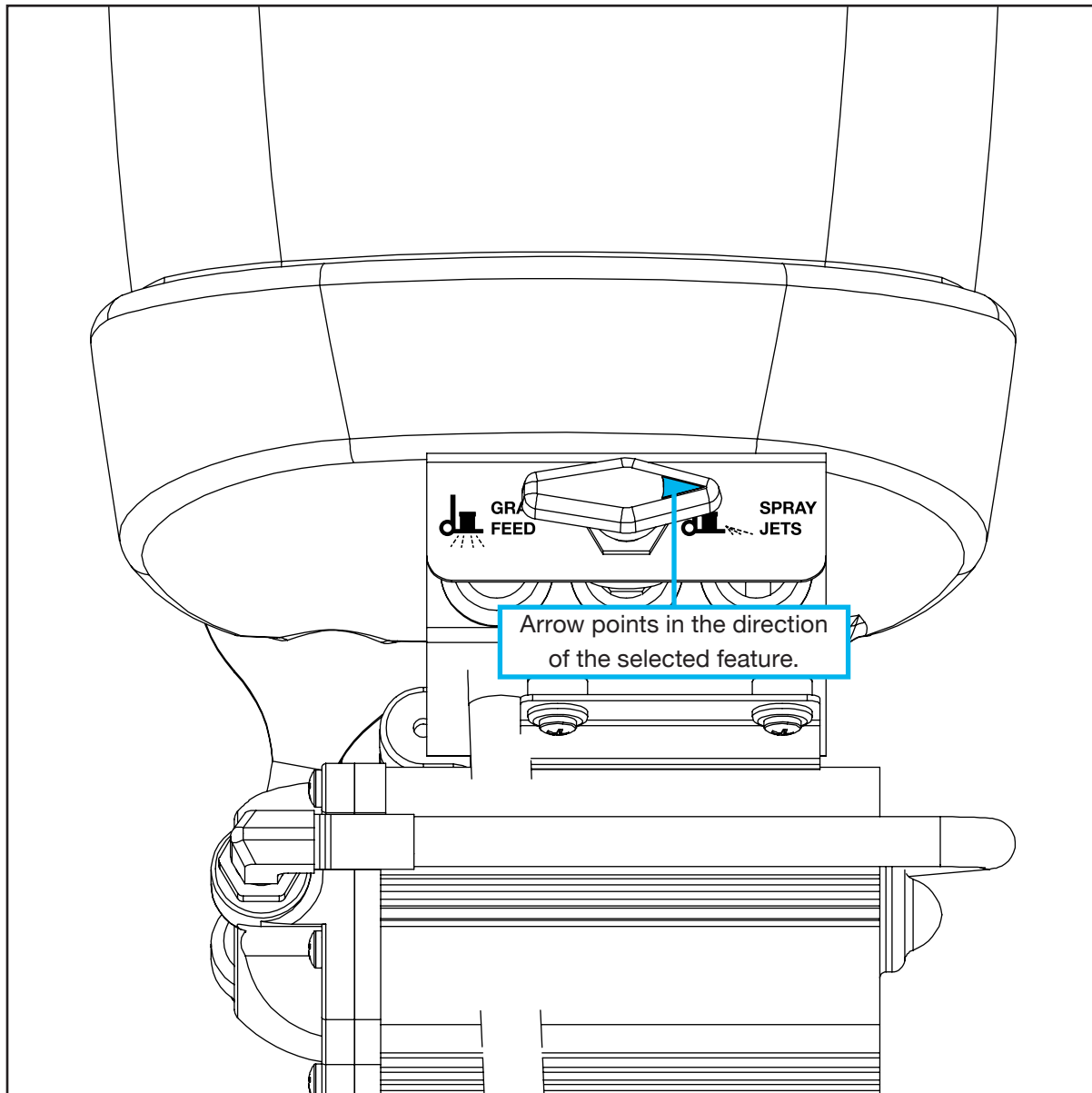

Gravity Feed

Water or shampoo solution is pumped down to the cleaning head, wetting the floor directly under the pad or brush.

Spray Jets

Water or shampoo solution is pumped out of the spray jets on the front on the machine, wetting the floor directly in front of the unit.

2 - MACHINE OPERATION

2.1 - Powering the Orbital Floor Machines

The Orbital Floor Machines require a 20 amp, 115V power outlet to operate.

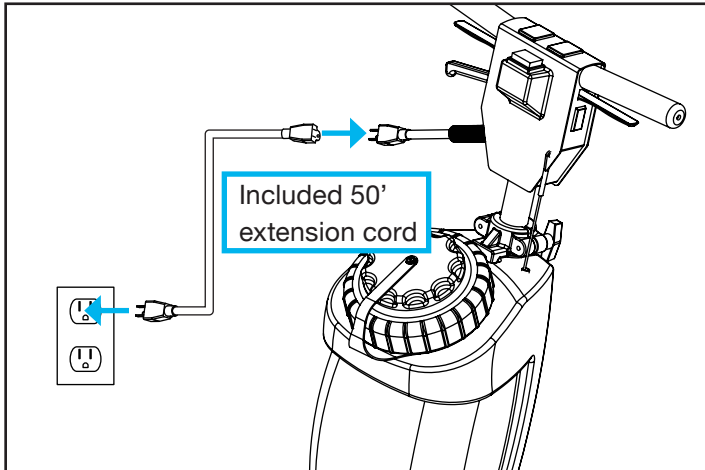

Plug the female end of the 50' lighted extension cord into the Orbital Floor Machine's pigtail power cord and plug the male end of the extension cord into a wall outlet. ♦

2.2 - Pad Drivers, Pads, and Brushes

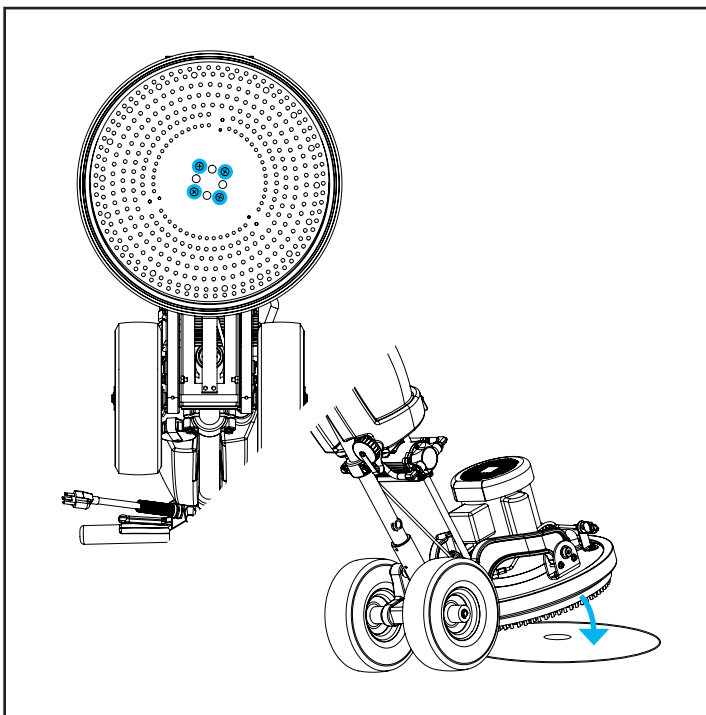

Pad Driver

The pad driver comes pre-installed on Mytee's Orbital Floor Machines. To remove the pad driver, undo the four screws on the bottom of the pad driver.

Applying Cleaning Pad

To apply a cleaning pad, just lower the machine with pad driver onto a 16" cleaning pad for the ECO-13 or a 19" pad for the ECO-17. Make sure the pad is as centered as possible on the pad driver with no driver bristles exposed to carpet.

Tile & Grout Brush

To apply the optional Tile & Grout Brush, remove the pre-installed pad driver via the four screws holding it in place. Screw the Tile & Grout Brush directly into the bearing just like the pad driver was.

Using the Optional Star Lok™ Driver Hub

Quickly switch between the Pad Driver and Tile & Grout Brush with the A145 Star Lok™ Driver Hub (sold separately). The Star Lok™ Driver Hub bolts onto the Orbital Floor Machine's bearing, eliminating the need for tools when swapping cleaning heads. Just slide one head off of the star-shaped Driver Hub and slide another on. ♦

2.3 - Filling the Shampoo Tank

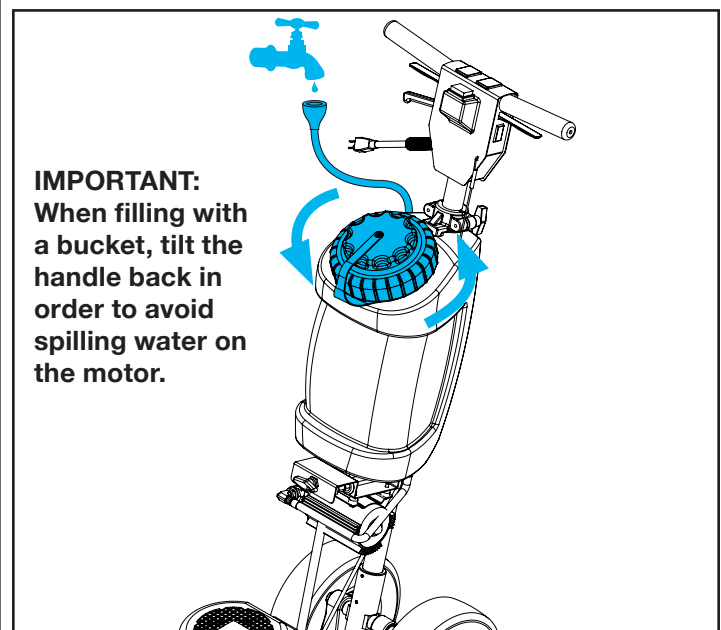

Faucet Fill

The shampoo tank can be filled from a standard faucet. Simply lift the Faucet Fill hose out of the tank and press it against the faucet. Turn on the faucet to allow water to flow down into the tank.

Bucket Fill

To fill using a bucket, twist off the shampoo tank cap counter-clockwise and pour in water. **IMPORTANT: Tilt back the handle before filling with a bucket in order to avoid spilling water on the motor causing damage.** Add shampoo or chemical if desired. ♦

2.4 - Operating the Orbital Floor Machine

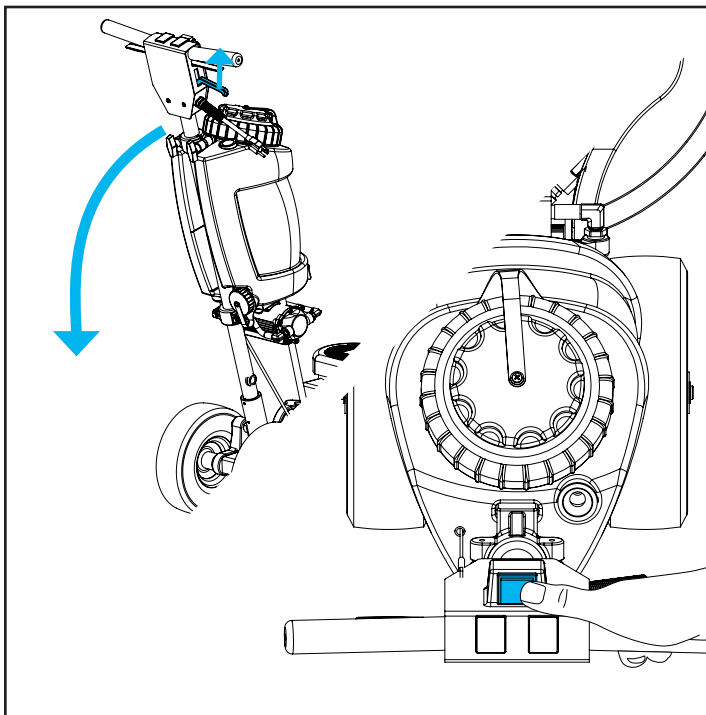

Switching On the Orbital Floor Machines

After plugging in the machine, lower the handle to a comfortable height and press the power switch on the handle to turn on the machine.

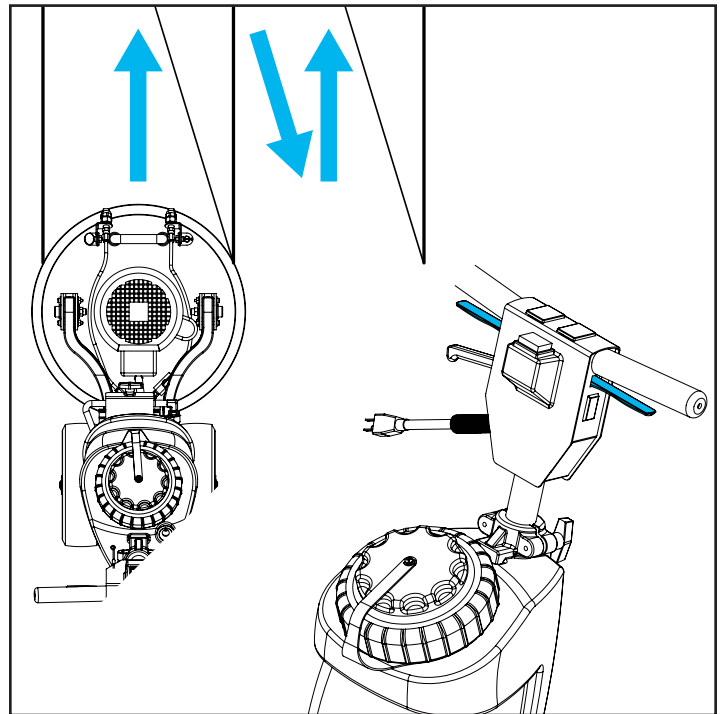

Running the Orbital Floor Machine

To effectively clean floors, move the Orbital Floor Machine forwards and backwards, similar to using a household vacuum cleaner. Wet the floor by spraying solution as you roll the unit forwards. ♦

2.5 - Emptying the Shampoo Tank

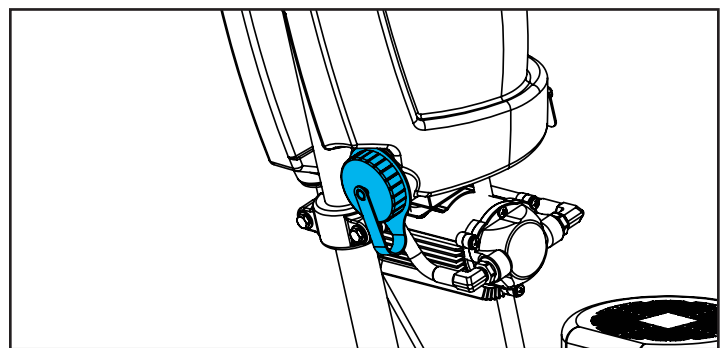

The shampoo tank can be easily emptied into a bucket by unscrewing the drain cap on the bottom of the tank.

IMPORTANT: Tilt the handle back in order to avoid spilling water on the motor while emptying. ♦

3 - MACHINE MAINTENANCE

In order to keep the Orbital Floor Machine running smoothly and reduce the risk of damage to the machine and subsequent downtime, Mytee recommends following the maintenance schedule shown to the right:

Maintenance Item	Daily	Weekly
Clean and inspect motor.	X	
Check power supply cable.	X	
Clean machine with all purpose cleaner and cloth.	X	
Inspect machine for water leaks and loose hardware.		X

3.1 - Flywheel Bearing Replacement

The flywheel bearing is a wear part, similar to rotors on a car. Over time, the bearing will require replacing.

Tools Needed:

- 7/16" open-ended wrench or socket
- 3/16" Allen wrench
- Blue Loctite®

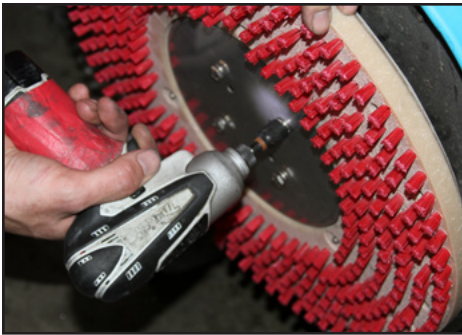

1. Remove the pad driver assembly by removing the four bolts with a 7/16" wrench or socket.

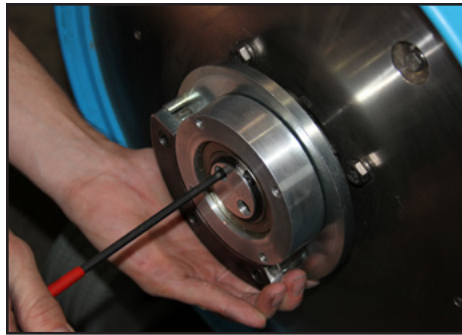

2. Using a 3/16" Allen wrench, undo the two Allen bolts holding the bearing onto the flywheel.



3. Remove the Allen bolts from the bearing and apply Blue Loctite®.

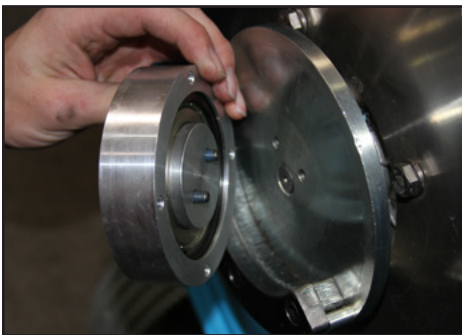

4. Insert the Allen bolts into the new bearing and line up the bolts with the holes on the flywheel.



5. Using the 3/16" Allen wrench, bolt the new bearing onto the flywheel.



6. Apply Blue Loctite® to the pad driver bolts and bolt it back onto the machine. ♦

3.2 - Flywheel Replacement

These instructions cover how to remove and replace the flywheel assembly on ECO-17 and ECO-13 models.

Tools Needed:

- 7/16" open-end wrench or socket
- 15/16" open-end wrench
- Soft-face dead blow mallet
- Anti-Sieze
- Flathead screwdriver
- Blue Loctite®



1. Remove the pad driver assembly by removing the four bolts with a 7/16" wrench or socket.



2. Hold the jam nut, located between the flywheel and motor, in place with a 15/16" open-end wrench. Using a mallet, tap the flywheel counter-clockwise to loosen.

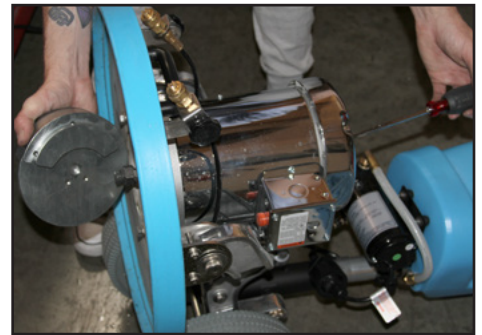

3. Remove the plastic plug from the top of the motor and hold the motor shaft in place by inserting a flathead screwdriver into the top of the shaft on top of the motor. Loosen the flywheel the rest of the way off with the other hand.



4. Apply Anti-Sieze to the motor shaft. To install the new flywheel, hold the motor shaft in place with the flathead screwdriver just like before and thread the new flywheel on with the other hand until it stops at the jam nut.



5. Use the 15/16" wrench to hold the jam nut in place and use a mallet to strike the flywheel counterweight to tighten the flywheel against the jam nut.



6. Apply Blue Loctite® to the pad driver bolts and bolt it back onto the machine. ♦

4 - TROUBLESHOOTING

4.1 - Machine Troubleshooting

Plug on the power cord doesn't light up when plugged in.	
Possible Causes	Solutions
Problem with the power cord.	Replace power cord. 38" Pigtail: Part # E575
Burnt out light.	No action needed or replace power cord. 38" Pigtail: Part # E575

Plug lights up when plugged in but machine does not turn on.	
Possible Causes	Solutions
Wires connecting to the switch may be loose or disconnected.	Open up the faceplate on the handle and check the switch for loose or disconnected wires. Re-connect any loose wires.
Bad power switch.	Replace switch. Part # H167
(120 volt units only) Motor circuit breaker may have tripped.	Make sure motor is first cooled down, then reset breaker by pressing button located on bottom of motor conduit box (see Figure A). Make sure that only the proper Mytee power cord extension is being used, and that it is good condition. If the problem persists or reoccurs, contact a Mytee Service Center.

Figure A

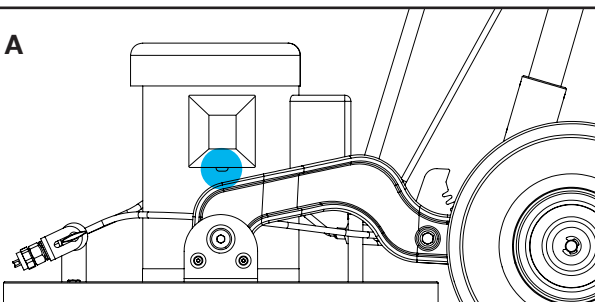

Motor is drawing too many amps and blowing breakers.	
Possible Causes	Solutions
Power cord is defective or damaged.	Replace power cord. 38" Pigtail: Part # E575
Power switch has shorts or loose connections.	Replace power switch. Part # H167
Power cord from the switch is defective or damaged.	Replace power cord. 38" Pigtail: Part # E575

Machine is making a loud grinding noise.	
Possible Causes	Solutions
Bearing failure.	Replace bearing (click for instructions). Install Part # A140 Kit if using gravity feed (click for instructions).

4.2 - Pump Troubleshooting

No water flow.	
Possible Causes	Solutions
Tank is empty.	Fill tank.
Filter is clogged.	Clean the filter.
Pump valves are clogged or damaged.	Examine the valves and clean or replace.

Low pressure.	
Possible Causes	Solutions
Work nozzle.	Replace nozzle with a new one of the same size.
Leak in high pressure hose or connections.	Check the hose and connections.
Filter is clogged.	Clean the filter.
Pump valves are clogged or damaged.	Examine the valves and clean or replace.

Pump pulsates when spraying.	
Possible Causes	Solutions
Filter is clogged.	Clean the filter.
Pump valves are clogged or damaged.	Examine the valves and clean or replace.

Leaks seen under pump.	
Possible Causes	Solutions
Worn pump seals.	Replace with new plunger and seals.
Abrasives in solution have damaged pump seals.	Mix chemical thoroughly and make sure filter is not damaged.

NOTES



Mytee Products, Inc.

13655 Stowe Dr.
Poway, CA 92064

www.mytee.com

© 2018 Mytee Products, Inc.
Printed in the USA

[New & Reconditioned Equipment & Parts - www.southeasternequipment.net](http://www.southeasternequipment.net)