

Advance Sprite® and Sprite Air Scoop™ Wet/Dry Tank Vacuums



DEFINING
CLEANING
INNOVATION



Sprite® and Sprite Air Scoop™
meet the demand for quality
and performance



Advance Sprite® and Sprite Air Scoop™ Wet/Dry Tank Vacuums

The Advance Sprite® and Sprite Air Scoop™ Wet/Dry Tank Vacuums are Truly Versatile Products for Many Time and Labor Saving Jobs.

With today's high cost of labor, why waste time with mops and buckets? Put an Advance Sprite® on the job and start saving money.

The Advance Sprite® is available in 12-gallon (45 L) or 16-gallon (60 L) tank sizes. It has a rugged, rotationally molded polyethylene tank that is corrosion proof and will not chip or dent.

It conveniently pivots on a hinge to dump its contents or drains through a built in hose. The entire tank lifts off for cleaning and allows total access for motor service or maintenance.

The powerful, yet quiet, 70 dB A, 1.3 hp 2-stage, by-pass motor is located under the tank for protection from water and debris. A float system stops recovery to prevent tank overflow.

For dry pick up, insert a sock filter or a reusable cloth bag, and use any of the dry pick up accessories. A washable exhaust filter helps assure dust containment.

Advance Sprite Air Scoop™ models pick up water faster than those with a hose and wand, they are especially effective in tight spots too. The 24-inch (60 cm) front-mounted squeegee maneuvers right up to walls and into corners, picking up either in forward or reverse. A simple floor pedal raises or lowers the squeegee, which is spring loaded to follow floor contours for thorough results.

Ideal Applications Include —

- Hospitals/Healthcare Facilities
- Schools and Universities
- Government Buildings and Installations
- Supermarkets
- Shopping Malls
- Warehouses
- Distribution Centers
- Retail Stores
- Airports



VALUE FEATURES



Save time and labor with the Air Scoop™ front mounted squeegee.



Rugged construction with durable components assures years of reliable performance.



Easy access motor can be released by removing four bolts.



Low sound level permits operation anywhere, anytime.

Rotomolded handle allows comfortable operating positions for all users

A built in float system automatically cuts off the vacuum air flow when the tank fills with liquid, preventing overflow

A cleanable, reusable filter keeps exhaust air clean and muffles vac motor sound

The Sprite includes an 8 piece wet or dry pick-up tool kit for complete versatility

A sock filter goes over the float assembly for dry pick up, and a cloth bag can be inserted into the tank for dry vacuum operation

A 1.3 hp motor is located under the tank for protection from water and debris

Tough polyethylene construction and functional design assure durability, dependability

Large rear wheels make transport easy, even up or down stairs

Front caster wheels provide "easy action" transport

The Sprite Air Scoop includes a 24 in (61 cm) front mounted squeegee



Roto-molded poly tank is hinged for tip and pour emptying. The tank can be completely removed from the base for easy clean-out.



Positioned at the lowest point in the tank, the drain hose provides an alternative draining method.



Simple design gives direct access to modular vac motor. Four bolts and motor is released for service or replacement.



The front mounted squeegee on the Sprite Air Scoop can increase productivity by 80% over manual pick up tools.



The base has an easy to use, rugged on/off switch. The Air Scoop models also have a pedal for operating the front mounted squeegee.

VALUE FEATURES

The Advance Sprite®, designed with Total Clean™ Technology, is very comfortable and safe to use — by design. The result is increased productivity. The Advance Sprite® is also designed with features to make it easy to clean up and maintain after cleaning. That reduces the total cost of ownership and drives down the cost of cleaning.





Manufacturer PDF Provided by www.southeasternequipment.net

Advance Sprite® and Sprite Air Scoop™

Increase your staff's efficiency with the Sprite® and Sprite Air Scoop™ wet/dry tank vacuums. The 24 inch (61 cm) front mounted squeegee on the Sprite Air Scoop™ can increase productivity by 80% over manual pick up tools, cleaning up to 11,500 square feet (1,068 m²) per hour. The tip and pour feature makes these rugged, versatile wet/dry vacuums convenient to use.

Defining Cleaning Innovation...

- Our products are designed using innovative technology that increases productivity and drives down the cost to clean.
- You can get expert service and maintenance for your products by factory-trained personnel around the world, as well as fast parts delivery.
- Maintain peak performance with genuine APA parts.



Optional Accessories

The Advance Sprite® comes with the standard 8 piece tool kit. The Advance Sprite Air Scoop™ comes standard with the 24 inch front mounted squeegee. A wide variety of optional accessories are also available for the Advance Sprite® and Sprite Air Scoop™.



Technical Specifications

	Sprite® 12/Air Scoop™	Sprite® 16/Air Scoop™
Motor	1.3 hp, 115 V / 60 Hz, 2-stage	1.3 hp, 115 V / 60 Hz, 2-stage
Air Flow	91 ft ³ /min (2,577 L/min)	91 ft ³ /min (2,577 L/min)
Sealed Waterlift	88 in (223 cm)	88 in (223 cm)
Squeegee Width	24 in (61 cm) Air Scoop 30 in (76 cm) (optional) Air Scoop	24 in (61 cm) Air Scoop 30 in (76 cm) (optional) Air Scoop
Cleaning Rate	11,500 ft ² /hr (1,068 m ² /hr) Air Scoop	11,500 ft ² /hr (1,068 m ² /hr) Air Scoop
Sound Level	70 dB A	70 dB A
Construction	roto-molded polyethylene tank	roto-molded polyethylene tank
Tank Capacity	12 gal (45 L) actual	16 gal (60 L) actual
Wheels	10 in x 1.75 in (25 x 4.5 cm) main 4 in x 1 in (10 x 2.5 cm) casters	10 in x 1.75 in (25 x 4.5 cm) main 4 in x 1 in (10 x 2.5 cm) casters
Power Cable	50 ft (15 m)	50 ft (15 m)
Dimensions	Height – 32 in (81 cm) Width – 17 in (43 cm) Length – 40.5 in (103 cm) Height (dome) – 32 in (81 cm) Height handle – 39.5 in (100 cm)	Height – 35 in (89 cm) Width – 17 in (43 cm) Length – 40.5 in (103 cm) Height (dome) – 35 in (89 cm) Height handle – 39.5 in (100 cm)
Net Weight	66 lb (30 kg) 72 lb (33 kg) Air Scoop	71 lb (32 kg) 77 lb (35 kg) Air Scoop
Shipping Weight	74 lb (34 kg) 80 lb (36 kg) Air Scoop	79 lb (36 kg) 85 lb (39 kg) Air Scoop
Part Numbers	56 209 071 Sprite 12 56 209 091 Sprite Air Scoop 12	56 209 072 Sprite 16 56 209 092 Sprite Air Scoop 16

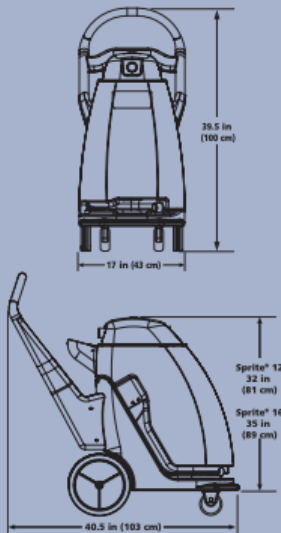

Specifications are subject to change without notice.



14600 21st Avenue North
Plymouth, MN 55447-3408
www.nilfisk-advance.com
Phone: 800-214-7700
Fax: 800-989-6566

396 Watline Avenue
Mississauga, Ontario, Canada L4Z 1X2
www.nilfisk-advance.com
Phone: 800-668-8400 or 905-712-3260
Fax: 800-263-5111 or 905-712-3255

©2004, Nilfisk-Advance, Inc., Printed in U.S.A., Form L0809A, 12-04